

SIEMENS

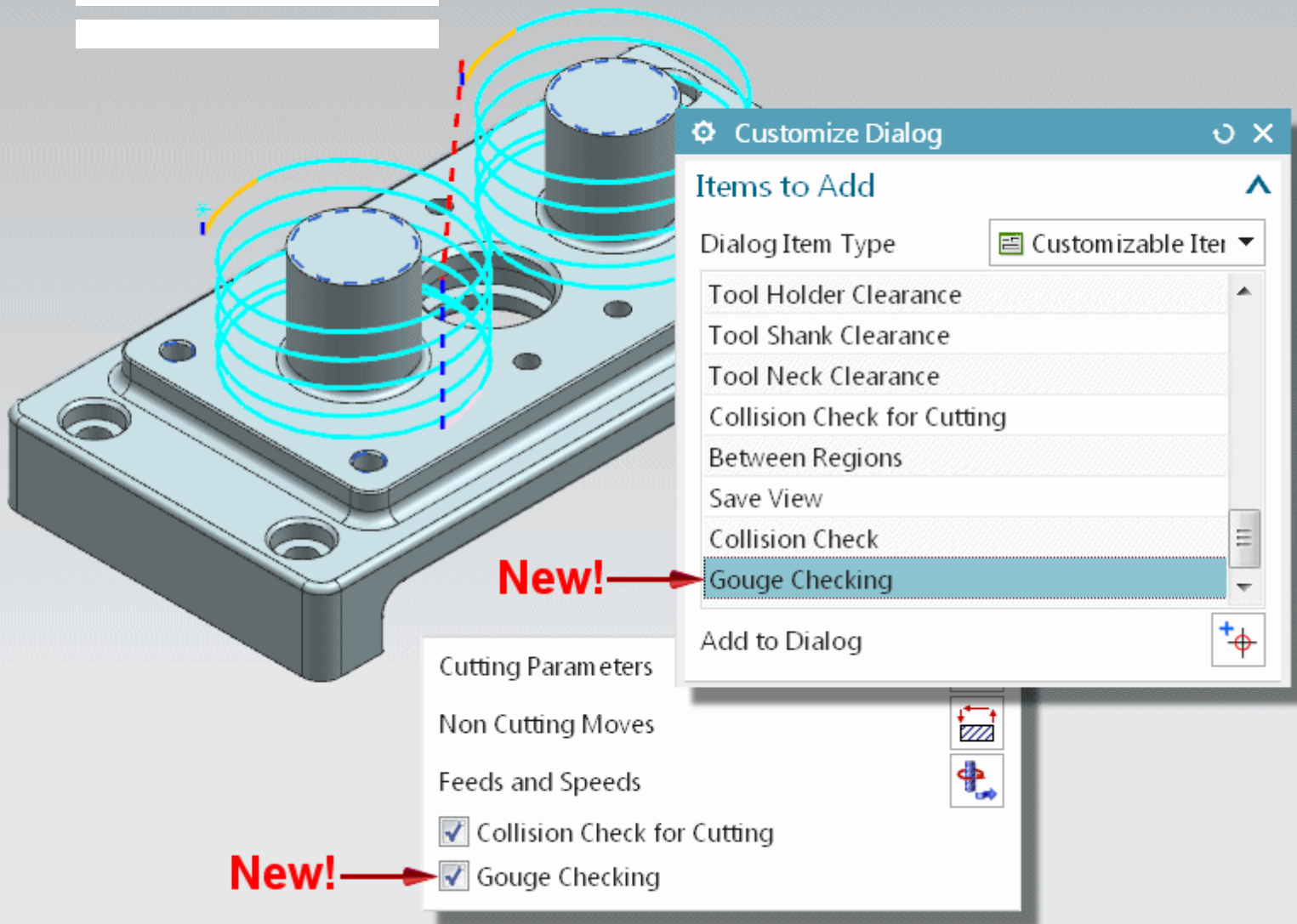

Siemens PLM Software

NX CAM 11: Gouge Checking Enhancements

Gouge checking for Hole Milling, Hole Chamfer Milling, Boss Milling, and Radial Groove Milling operations.

Answers for industry.

About NX CAM

NX™ CAM software has helped many of the world's leading manufacturers and job shops produce better parts faster. You can also achieve similar benefits by making use of the unique advantages NX CAM offers.

This is one of many hands-on demonstrations designed to introduce you to the powerful capabilities in NX CAM 11. In order to run this demonstration, you will need access to NX CAM 11.

Visit the [NX Manufacturing Forum](#) to learn more, ask questions, and share comments about NX CAM.

Hands-on Demonstration: Gouge Checking Enhancements

Gouge Checking is now available for Hole Milling, Hole Chamfer Milling, Boss Milling, and Radial Groove Milling operations. This enhancement makes these operation types consistent with the other Hole Making operation types. For Boss Drilling and Radial Groove Milling operations, Gouge Checking must be customized into the operation dialog box.

	NX10.0.3		NX11	
Spot Drilling				
Drilling				
Deep Hole Drilling				
Countersinking				
Back Countersinking				
Tapping				
Hole Milling	(must be customized)	---		New!
Hole Chamfer Milling		---		New!
Sequential Drilling				
Boss Milling	(must be customized)	---	(must be customized)	New! (must be customized)
Thread Milling		(must be customized)		(must be customized)
Boss Thread Milling	(must be customized)	(must be customized)	(must be customized)	(must be customized)
Radial Groove Milling		---		New! (must be customized)

 = Collision Check for Cutting
 = Gouge Checking

Prerequisites:

1. You will need access to **NX CAM 11** in order to run this demonstration.
2. If you haven't done so already, download and unzip **gouge_checking_enhancements.7z**.

Demo:

1. Open **gouge_check.prt** in NX.

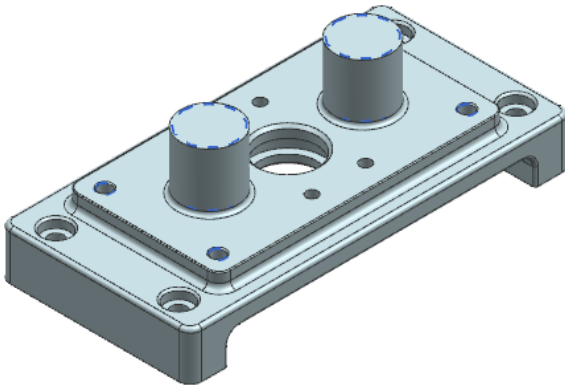

2. Double-click **HOLE_MILLING** to edit the operation.

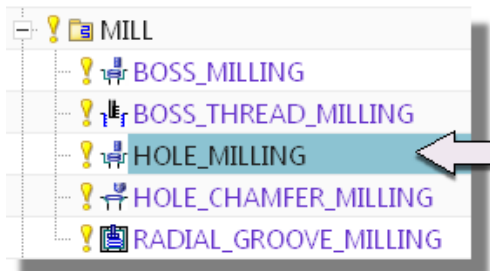

Gouge Checking is now available for Hole Milling operations. **Collision Check for Cutting** no longer needs to be customized into the dialog box. Both options default to off.

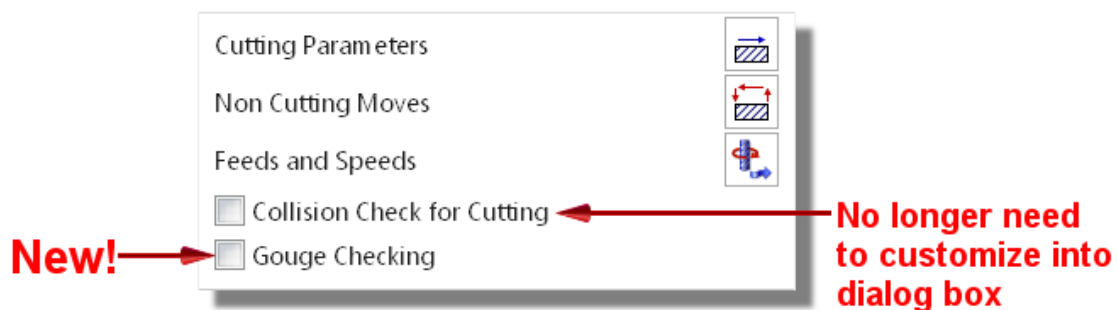

3. Click **Cancel**.

4. Double-click **HOLE_CHAMFER_MILLING** to edit the operation.

Gouge Checking is now available for Hole Chamfer Milling operations. The default is on.

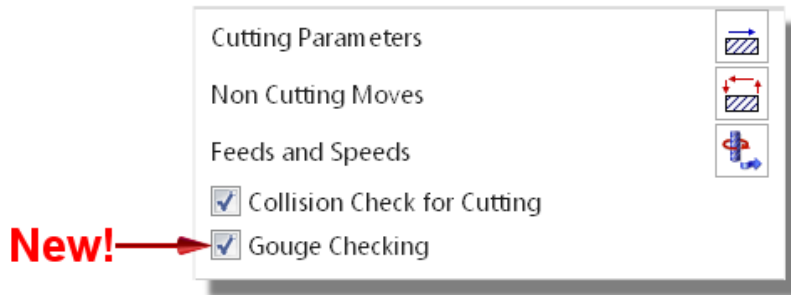

5. Click **Cancel**.

Gouge Checking is now available for Boss Milling operations but it must be customized into the dialog box.

6. Double-click **BOSS_MILLING** to edit the operation.
7. In the **Options** section of the dialog box, click **Customize Dialog** .
8. In the **Items Used** section of the dialog box, expand **Group:Path Settings**, scroll down and select **Feed**.

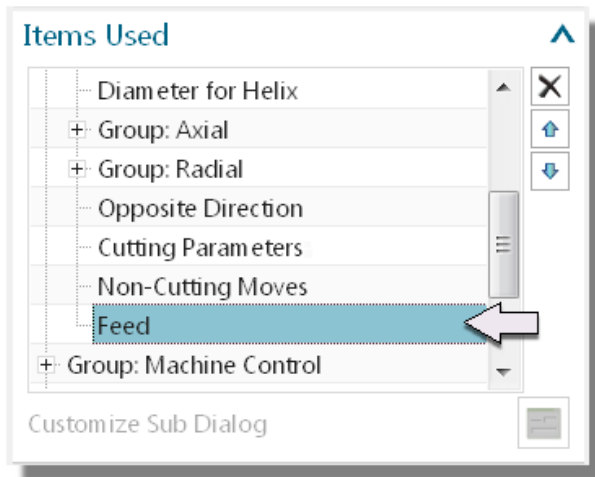

9. Scroll to the bottom of the **Items to Add** list and select **Gouge Checking**.

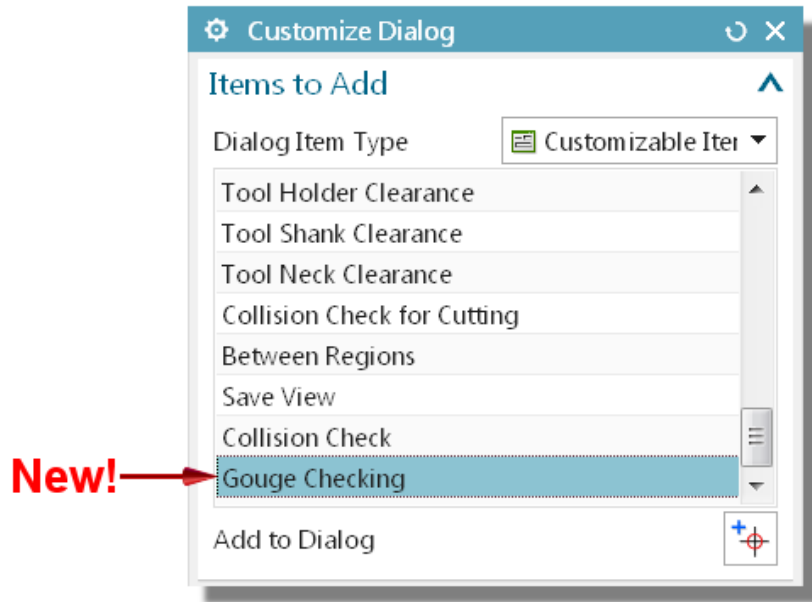

10. Click **Add to Dialog** .
11. Click **OK**.

Gouge Checking has been added to the dialog box. The default is off.

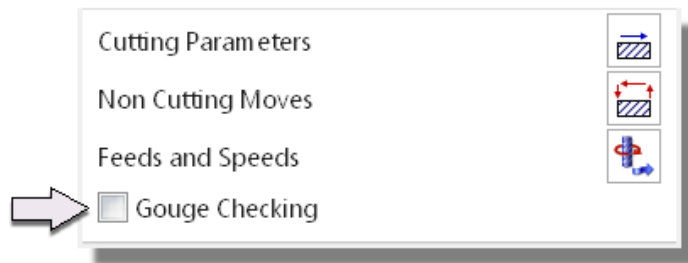

12. Click **OK** to finish editing the operation.

Gouge Checking is now available for Radial Groove Milling operations but it must be customized into the dialog box.

13. Double-click **RADIAL_GROOVE_MILLING** to edit the operation.

14. In the **Options** section of the dialog box, click **Customize Dialog** .

15. In the **Items Used** section of the dialog box, expand **Group:Path Settings**, scroll down and select **Collision Check for Cutting**.

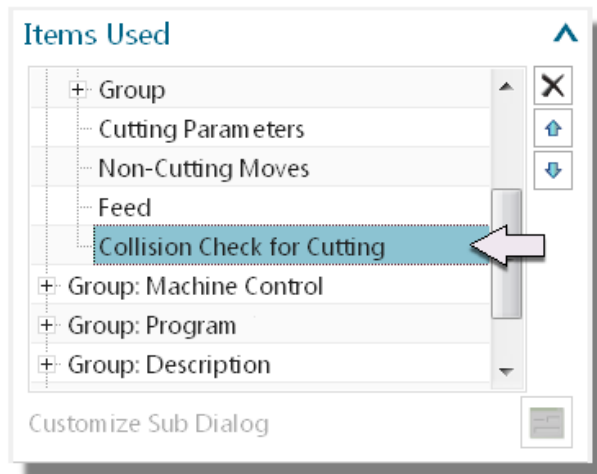

16. Scroll to the bottom of the **Items to Add** list and select **Gouge Checking**.

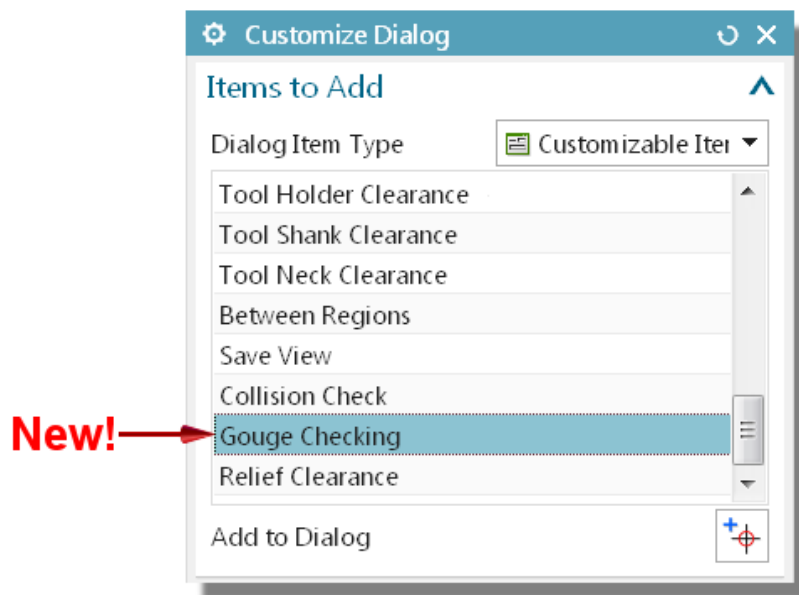

17. Click **Add to Dialog** .
18. Click **OK**.

Gouge Checking has been added to the dialog box. The default is on.

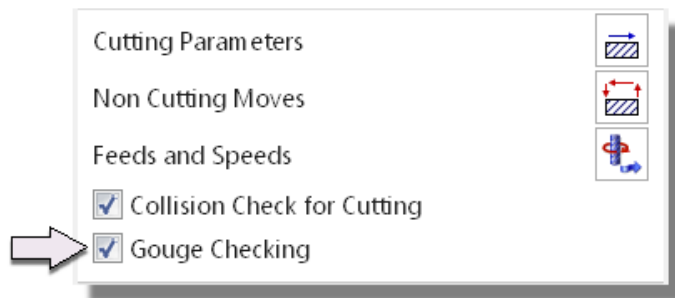

19. Click **OK** to finish editing the operation.

20. Close the part without saving.

Siemens Industry Software

Headquarters

Granite Park One
5800 Granite Parkway
Suite 600
Plano, TX 75024
USA
+1 972 987 3000

Americas

Granite Park One
5800 Granite Parkway
Suite 600
Plano, TX 75024
USA
+1 314 264 8499

Europe

Stephenson House
Sir William Siemens Square
Frimley, Camberley
Surrey, GU16 8QD
+44 (0) 1276 413200

Asia-Pacific

Suites 4301-4302, 43/F
AIA Kowloon Tower, Landmark East
100 How Ming Street
Kwun Tong, Kowloon
Hong Kong
+852 2230 3308

About Siemens PLM Software

Siemens PLM Software, a business unit of the Siemens Industry Automation Division, is a leading global provider of product lifecycle management (PLM) software and services with seven million licensed seats and more than 71,000 customers worldwide. Headquartered in Plano, Texas, Siemens PLM Software works collaboratively with companies to deliver open solutions that help them turn more ideas into successful products. For more information on Siemens PLM Software products and services, visit www.siemens.com/plm.

© 2016 Siemens Product Lifecycle Management Software Inc. Siemens and the Siemens logo are registered trademarks of Siemens AG. D-Cubed, Femap, Geolus, GO PLM, I-deas, Insight, JT, NX, Parasolid, Solid Edge, Teamcenter, Tecnomatix and Velocity Series are trademarks or registered trademarks of Siemens Product Lifecycle Management Software Inc. or its subsidiaries in the United States and in other countries. All other logos, trademarks, registered trademarks or service marks used herein are the property of their respective holders.