

6

5

4

3

2

1

REV	DESCRIPTION	DATE
000	INITIAL DESIGN	

NOTES:

- 1. ALL DIMENSIONS APPLY AFTER PLATING.
- 2. USE RoHS COMPLIANT PARTS AND PROCESS.

14-JUN-2016 11:28
NOT RELEASED

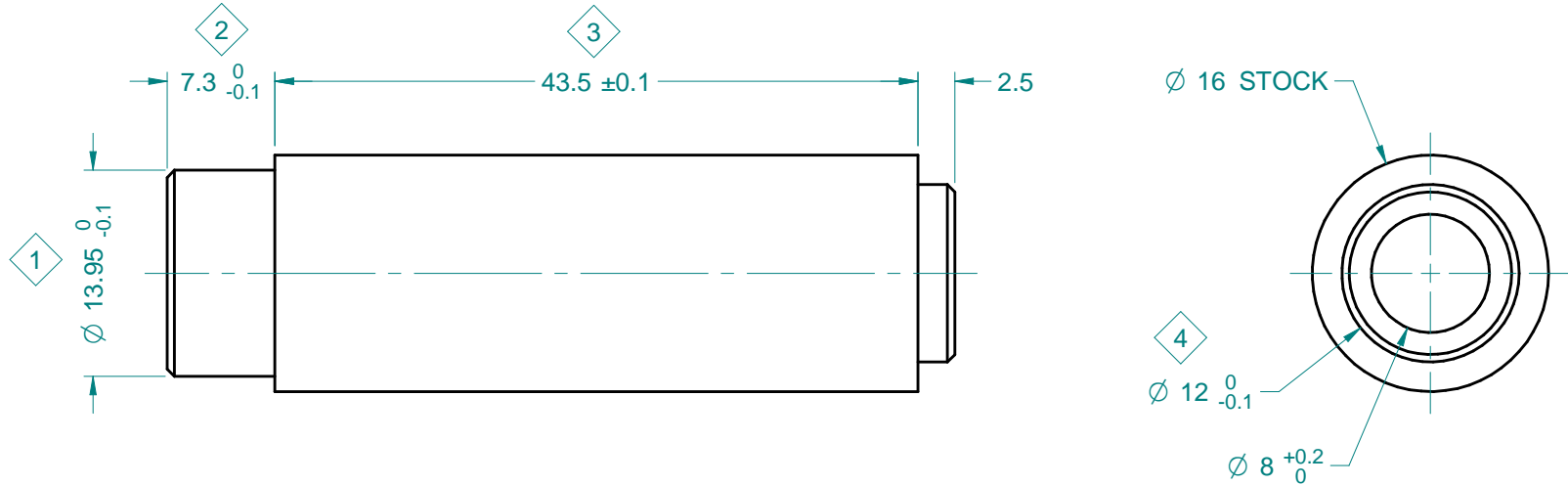

DIM. FOR INSPECTION	
DIM #	LOCATION
1	C-6
2	C-5
3	C-4
4	B-2

CE DOCUMENT EST LA PROPRIETE EXCLUSIVE DE SAVARIA ET NE PEUT ETRE UTILISE OU REPRODUIT SANS UNE AUTORISATION ECRITE. THIS DOCUMENT IS THE SOLE PROPERTY OF SAVARIA AND CANNOT BE USED OR REPRODUCED WITHOUT A WRITTEN AUTHORIZATION		MATERIAU / MATERIAL : Error: No reference		 MAGOG, CANADA	
BRISER TOUTES LES ARETES VIVES REMOVE ALL SHARP EDGES		FINI / FINISH : Error: No reference			
METRIC 		GD&T AS PER ASME Y14.5M-2009 NON SPECIFIED TOLERANCE ISO 2768 - m K		TITRE / TITLE Error: No reference	
		DRAWN mcorriveau	14-JUN-2016	SIZE A	DRAWING NUMBER
APPROVED		SCALE 2:1		STATUS PROTOTYPE	
				SHEET 1 / 2	

6

5

4

3

2

1

SAVARIA-1.A

6

5

4

3

2

1

REV	DESCRIPTION	DATE
000	INITIAL DESIGN	

NOTES:

- DIMENSIONS NOT SHOWN ARE TAKEN FROM BASIC CAD MODEL
- ALL DIMENSIONS APPLY AFTER PLATING.
- ALL WELDING SYMBOLS ARE ACCORDING TO STANDARD AWS A2.4:2007 (American Welding Society).
- MASK THE SURFACES IDENTIFIED WITH THIS SYMBOL: NO PAINT IS ALLOWED ON THOSE SURFACES.
- UNLESS OTHERWISE SPECIFIED ALL DIMENSIONS APPLY BEFORE PAINTING.
- USE RoHS COMPLIANT PARTS AND PROCESS.



14-JUN-2016 11:28
NOT RELEASED

D

D

C

C

B

B

A

A

CE DOCUMENT EST LA PROPRIETE EXCLUSIVE DE SAVARIA ET NE PEUT ETRE UTILISE OU REPRODUIT SANS UNE AUTORISATION ECRITE. THIS DOCUMENT IS THE SOLE PROPERTY OF SAVARIA AND CANNOT BE USED OR REPRODUCED WITHOUT A WRITTEN AUTHORIZATION	MATERIAU / MATERIAL : Error: No reference		 MAGOG, CANADA		
	FINI / FINISH : Error: No reference				
BRISER TOUTES LES ARETES VIVES REMOVE ALL SHARP EDGES	GD&T AS PER ASME Y14.5M-2009 NON SPECIFIED TOLERANCE ISO 2768 - m K	3.2/ 	TITRE / TITLE Error: No reference		
METRIC	DRAWN mcorriveau 14-JUN-2016	VERIFIED	SIZE A	DRAWING NUMBER	REV
	APPROVED	SCALE 1:1	STATUS PROTOTYPE	SHEET 2 / 2	

6

5

4

3

2

1

SAVARIA-1.A